



STB FRONT PANEL QUICK-START GUIDE

- 1 Connect the USB cable to the P4 USB connector on the STB Front Panel board.



- 2** Connect the USB cable to a PC's USB port.

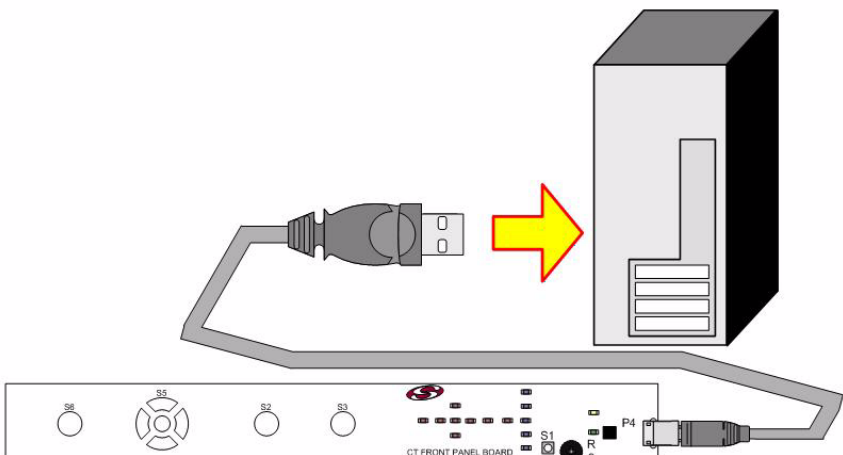

- 3 Wait for enumeration to complete. Watch for the LED labeled PWR to turn on.

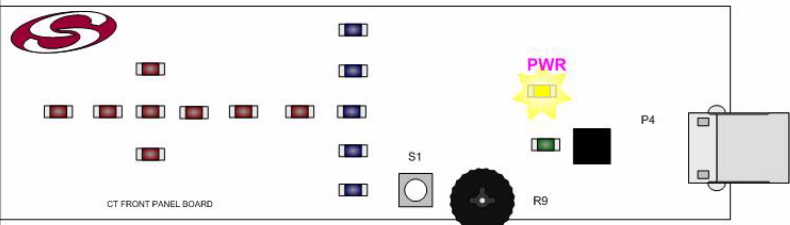

- 4 Move a hand in close proximity to the board. This causes the array of blue LEDs to light up as the hand approaches. Adjust proximity sensitivity by rotating the potentiometer R9.

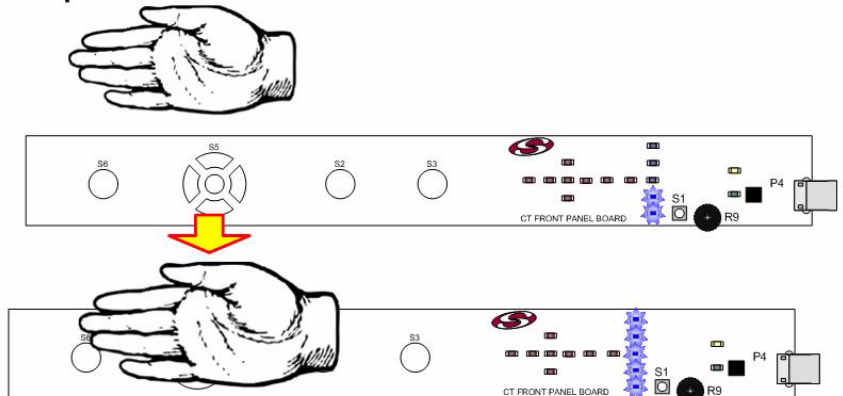

- 5** Press the Sx capacitive sensing buttons on the board. Each will light a corresponding red LED when firmware senses a finger's presence.

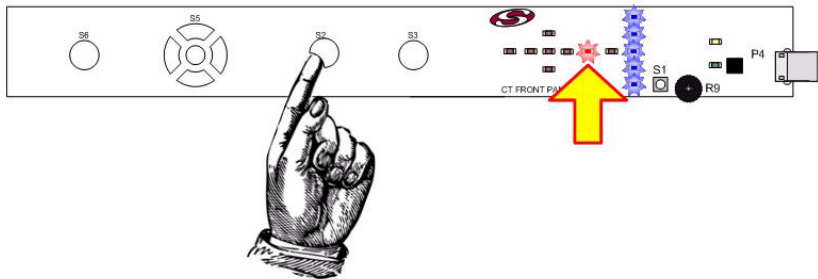

- 6** Read the STB Front Panel User's Guide for more information. Documentation and software are available at:
<https://www.silabs.com/FrontPanel>

